

SINGLE COLOR LED



1102W Standard Type with Inner Lens

S T A N D A R D C O L O R

Outline Dimensions

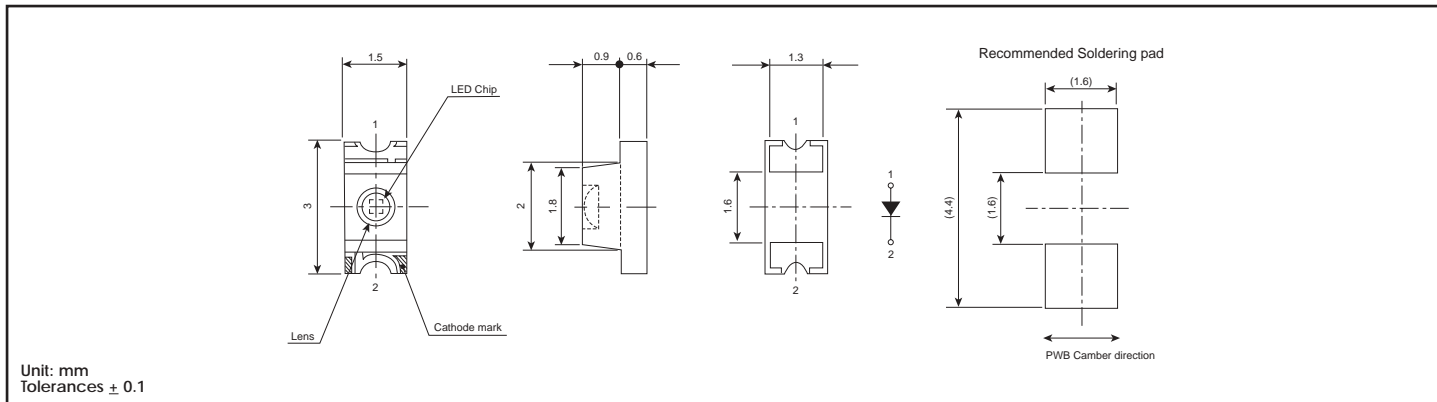

Absolute Maximum Ratings

(Ta=25°C)

Item	Symbol	Red	Orange	Yellow	Yellow Green	Green	Pure Green	Units
		BR	AA	AY	PY	PG	BG	
Power Dissipation	Pd	60	75	75	75	75	75	mW
Forward Current	I _F	30	30	30	30	30	30	mA
Peak Forward Current	I _{FM}	70	70	70	70	70	70	mA
Reverse Voltage	V _R	4	4	4	4	4	4	V
Operating Temperature	T _{opr}	-30 to +85						°C
Storage Temperature	T _{stg}	-40 to +100						°C
Derating*	ΔI _F	0.42 (DC) 0.93 (Pulse)						mA/°C

* Ta=25°C, I_{FM} applies for the pulse width ≤ 1msec. and duty cycle ≤ 1/20.

Electro-Optical Characteristics

*The viewing angle is an average and will vary by color (Ta=25°C)

Part No.	Material	Emitted Color	Lens Color	Luminous Intensity I _v			Wavelength				Forward Voltage V _f			Reverse Current I _R		Viewing Angle (2θ 1/2)
				MIN.	TYP.	I _F	Peak λ _p TYP.	Dominant λ _d TYP.	Spectral Line Half Width		TYP.	MAX.	I _F	MAX.	V _R	
									Δλ	Δλ						
BR1102W	GaAlAs	Red	Water Clear	12.0	33.6	20	660	647	30	20	1.7	2.0	20	100	4	70°
AA1102W	GaAsP	Orange		5.0	9.0	20	605	606	30	20	2.2	2.5	20	100	4	
AY1102W	GaAsP	Yellow		3.0	6.0	20	580	590	30	20	2.2	2.5	20	100	4	
PY1102W	GaP	Yellow Green		12.0	24	20	570	572	30	20	2.1	2.5	20	100	4	
PG1102W	GaP	Green		6.0	12	20	560	567	30	20	2.1	2.5	20	100	4	
BG1102W	GaP	Pure Green		1.8	4.8	20	555	558	30	20	2.1	2.5	20	100	4	
Units				mcd	mA		nm		mA		V	mA		μA	V	Deg.

Spatial Distribution

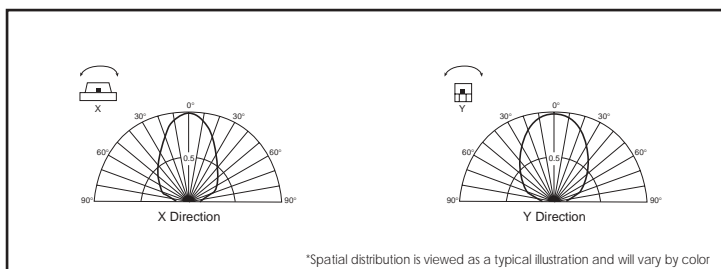

Operation Current Derating Chart

